

**INNOVATIVE CUSTOM DESIGNED HARDWARE IS OUR SPECIALTY**

REV. 02/07

TABLE 1

BEZEL --MOLDED-- COLOR (Matte Texture Per M.T.1055)	END LATCH --POWDER COAT-- COLOR
BAC 7363 (WHITE) = GE # GY9015	BAC 870 (BEIGE)
BAC 7363 (WHITE) = GE # GY9015	BAC 7363 (WHITE)
BAC 7363 (WHITE) = GE # GY9015	BAC 7363 (WHITE)
BAC 7363 (WHITE) = GE # GY9015	BAC 870 (BEIGE)

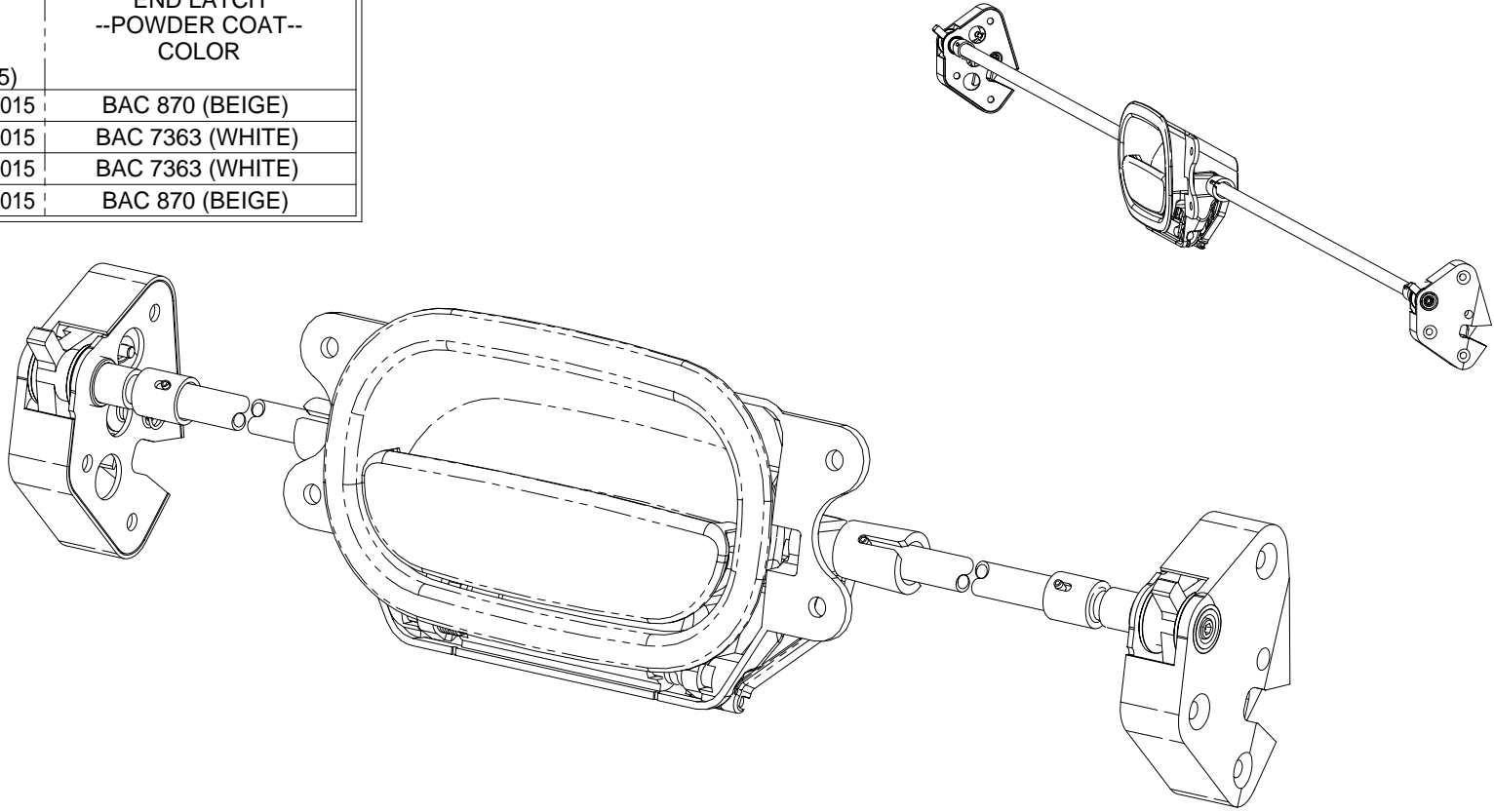

**MATERIAL:**  
 HOUSING & LINK: ULTEM 2300 (NATURAL/GLASS FILL)  
 BEZEL: ULTEM 9075 (SEE TABLE 1 FOR COLOR)  
 HANDLE: ALUM  
 TORQUE TUBE: ALUM  
 END LATCH HOUSING: ALUM  
 CAM, PLATE & UNIVERSAL: ALUM  
 STRKE: CRES  
 ARM & DRIVER: MDS FILLED NYLON 6/6  
 SHAFT: NYLON 6/6

**DECRETIVE FINISH:**  
 HANDLE: BRUSHED SATIN FINISH;  
 PLUS CLEAR PLOYURETHANE  
 END LATCH HOUSING: POWDER COAT  
 (SEE TABLE 1 FOR COLOR)

**WEIGHT:** XX LBS

**PIVOT BIN LATCH ASSY**  
 [FITS 747 / 767 / 777 PIVOT BINS  
 (Outbd, Center, Inbd): ALL LENGTHS]  
 MEETS BOEING SCD # S422W003  
 LOCKING LATCH ALSO AVAILABLE

ALL INFORMATION ON THIS DRAWING IS PROPRIETARY TO HARPER ENGINEERING COMPANY.  
 All design, manufacturing, reproduction, use and sale rights regarding the same are expressly reserved except that this drawing may be reproduced by the government of the United States of America only for distribution to government activities and/or personnel for purposes of maintenance, supply identification, stock listing and other related uses. All patent rights hereto are expressly reserved by  
**Harper Engineering Co.**

**UNLESS OTHERWISE SPECIFIED**  
 ALL DIM ARE REFERENCE  
 DIMENSIONS ARE IN INCHES ± .010  
 ANGULAR DIMENSIONS ARE IN DEGREES ± 1°  
 BREAK ALL CORNERS  
 INTERNAL & EXTERNAL RADII .030 MAX  
 MAXIMUM DRAFT 2°  
 Code Ident No. 34941

**Harper Engineering Co.**  
 200 S. Tobin St. Renton, Washington 98055  
 TITLE H3-1758  
 PIVOT BIN LATCH